



INSTALLATION GUIDE

Powerpedal

The product described in the guidance was developed, manufactured and controlled considering the necessary safety requirements.

The product must be installed properly to ensure a proper function and avoid danger for persons and things.

Please read this installation guide inclusive safety instructions carefully.

Scope of supply

Quantity	Article
1x	gaspedal tuning
1x	Fastening kit

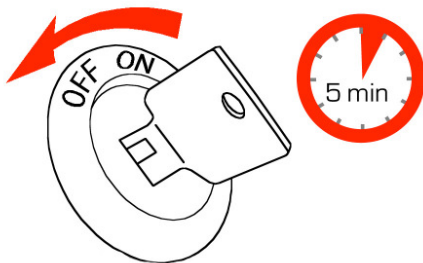

1. Turn the ignition off
2. Remove the ignition key!
3. Wait 5 minutes before installing the kit



In order to avoid damages at electronic vehicle components, you have to be sure that you have done all necessary methods for **electrostatic discharge** .

Install the electronic in an **waterproof** and **vibrationless** place. Do not make any changes at the tuning-kit!

Do not expand or shorten the loom.

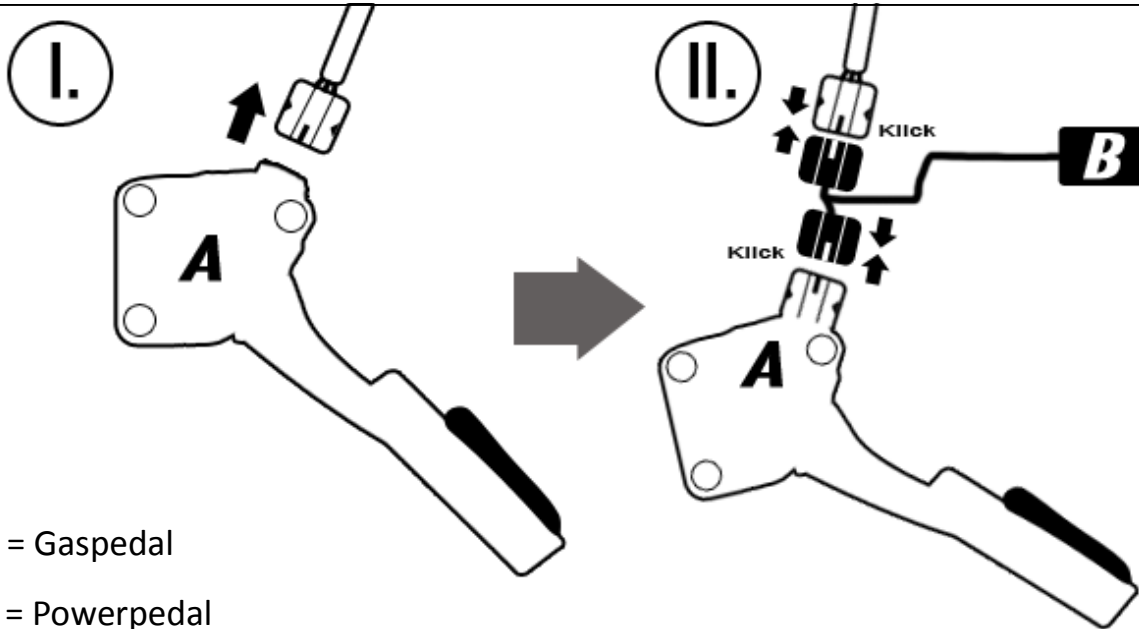

I. Find the gaspedal sensor in the footwell. It is located directly at the gaspedal. Detach the plug from the gaspedal.

II. Now attach the plug from the powerpedal to the gaspedal. Afterwards connect the original plug to the powerpedal. Install the powerpedal and the switch to a proper position.

III. Switch the powerpedal on using the switch

Ready! Now you can step on the gas

The switch



inactive

original gaspedal signal



dynamic

40% more direct response



sporty

75% more direct response

NOTE: The powerpedal has to be switched on after switching the car off. On „Start&Stop“ automatics the powerpedal will stay active.